

Wheels and castors with polyurethane tread

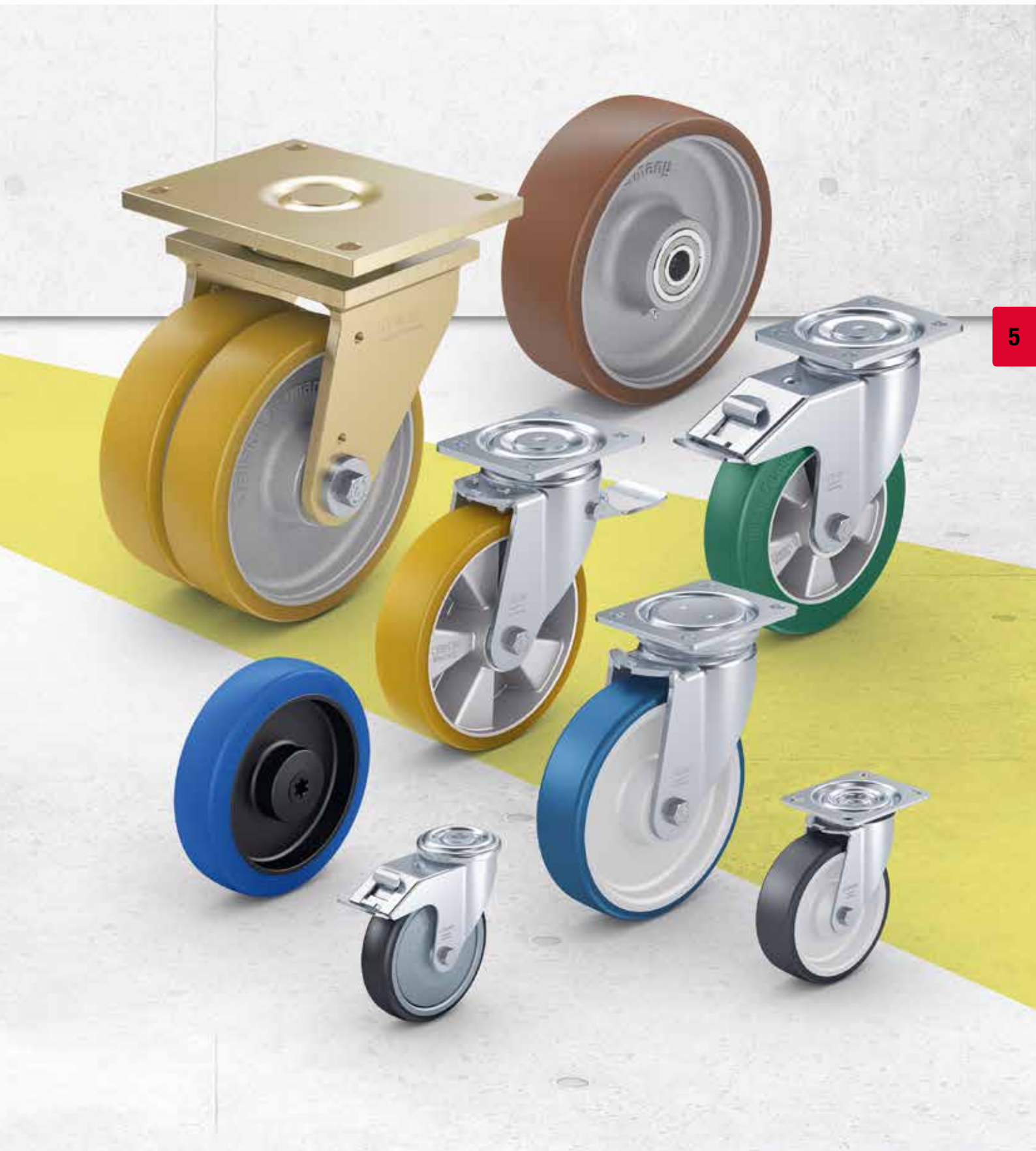



ALST	GST	ALB	VSB / GB	POBS	ALBS	GVU
Standard polyurethane		Premium polyurethane				
Polyurethane-elastomer Blickle Softhane®		Polyurethane elastomer Blickle Besthane®		Polyurethane elastomer Blickle Besthane® Soft		Vulkollan®
75 Shore A	75 Shore A	92 Shore A	92 Shore A	75 Shore A	75 Shore A	92 Shore A
optional	optional	–	optional	–	–	–
aluminium	grey cast iron	aluminium	VSB: steel GB: grey cast iron	nylon	aluminium	grey cast iron
80–300 mm	125–400 mm	100–250 mm	80–1,000 mm	80–200 mm	80–300 mm	100–400 mm
1,150 kg	3,000 kg	1,250 kg	30,000 kg	500 kg	1,150 kg	3,000 kg
10 km/h	10 km/h	16 km/h	16 km/h	4 km/h	16 km/h	16 km/h
–	–	–	–	✓	–	–
page 294	page 301	page 307	page 312–313	page 318	page 319	page 326
page 295–300	page 302–306	page 308–311	page 314–317	–	page 320–325	–

5

ALB series

Heavy-duty wheels
with **Blickle Besthane®** polyurethane tread,
with aluminium wheel centre



400–1,250 kg

Tread and tyre hardness

92 Shore A

Smooth operation / floor preservation

good

Rolling resistance

excellent

Wear resistance

excellent



Tread:

- high-quality polyurethane elastomer Blickle Besthane®, hardness 92 Shore A
- very low rolling resistance
- **high dynamic load capacity**
- high abrasion resistance
- high cut and tear propagation resistance
- colour brown, non-marking, non-staining
- excellent chemical connection with the wheel centre

Wheel centre:

- die-cast aluminium

Other features:

- high chemical resistance to many aggressive substances
- operating temperature: -20 °C to +70 °C, temporarily up to +90 °C, reduced load capacity over +40 °C

Additional details:

- wheel series: page 67
- tread: page 56
- bearing types: page 84–85
- chemical resistance: page 51

Wheels	Wheel Ø (D) [mm]	Wheel width (T2) [mm]	Load capacity at 4 km/h [kg]	Load capacity at 10 km/h [kg]	Load capacity at 16 km/h [kg]	Bearing type	Axle bore Ø (d) [mm]	Hub length (T1) [mm]
ALB 101/15K *	100	40	400	–	–	ball bearing	15	40
ALB 125/15K	125	40	550	–	–	ball bearing	15	45
ALB 150/20K	150	50	650	320	240	ball bearing	20	60
ALB 152/20K *	150	54	900	450	310	ball bearing	20	60
ALB 160/20K	160	50	750	370	280	ball bearing	20	60
ALB 162/20K *	160	50	950	470	330	ball bearing	20	60
ALB 181/20K	180	44	650	320	240	ball bearing	20	44
ALB 200/20K	200	50	800	400	300	ball bearing	20	60
ALB 202/20K *	200	50	1,000	500	350	ball bearing	20	60
ALB 250/25K	250	60	1,000	500	350	ball bearing	25	70
ALB 252/25K *	250	60	1,250	620	430	ball bearing	25	70

* With heavy-duty wheel centre, reinforced design

5

Versions / options



version with heavy duty wheel centre, reinforced design

other shore hardnesses and special colours

Technical description page

Product code suffix

Available for

upon request

ball bearing reinforced design

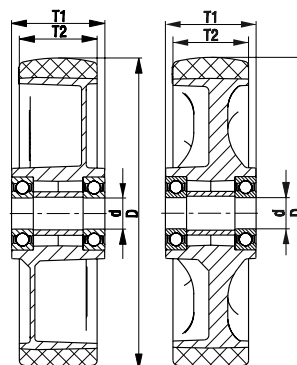

L-ALB, B-ALB, BH-ALB series

Pressed steel castors, medium-duty version, with top plate, wheel with Blickle Besthane® polyurethane tread

250–500 kg

Bracket: L/B/BH series

- pressed steel, zinc-plated, blue-passivated, Cr6-free

Swivel bracket:

- double ball bearing in the swivel head
- strong central kingpin (from wheel Ø 150 mm)
- swivel head seal
- minimum swivel head play and smooth rolling characteristic and increased service life due to the special dynamic Blickle riveting process

Wheel: ALB series

- tread: high-quality polyurethane elastomer Blickle Besthane®, hardness 92 Shore A, colour brown, non-marking, non-staining
- wheel centre: die-cast aluminium, colour silver grey

Additional details:

- bracket series: page 91
- brakes: page 112–113
- wheel series: page 307
- bearing types: page 84–85



5

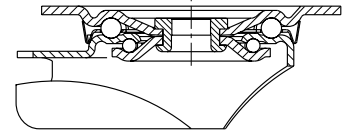

Swivel castors	Fixed castors	Swivel castors with "stop-fix" brake	Wheel Ø [mm]	Wheel width [mm]	Load capacity [kg]	Bearing type	Total height [mm]	Plate size [mm]	Bolt hole spacing [mm]	Bolt hole Ø [mm]	Offset swivel castor [mm]
L-ALB 101K	B-ALB 101K	L-ALB 101K-FI	100	40	250	ball bearing	125	100 x 85	80 x 60	9	35
L-ALB 125K	B-ALB 125K	L-ALB 125K-FI	125	40	250	ball bearing	150	100 x 85	80 x 60	9	38
L-ALB 150K	B-ALB 150K	L-ALB 150K-FI	150	50	400	ball bearing	190	140 x 110	105 x 75–80	11	60
L-ALB 160K	B-ALB 160K	L-ALB 160K-FI	160	50	400	ball bearing	195	140 x 110	105 x 75–80	11	60
L-ALB 200K	B-ALB 200K	L-ALB 200K-FI	200	50	400	ball bearing	235	140 x 110	105 x 75–80	11	65
L-ALB 250K-3	BH-ALB 250K	*	250	60	500	ball bearing	295	140 x 110	105 x 75–80	11	77

* "stop-top" brake version, see versions / options

Versions / options



	with "stop-top" brake	with "central-stop" central brake system	directional lock (separate) 1 x 360°	directional lock (separate) 1 x 360°	with steel foot guard
Technical description page	112	113	115	115	116
Product code suffix	-ST	-CS11	RI-03.01	RI-05.03	-FS
Available for	all	wheel Ø 160–200 mm	wheel Ø 100–125 mm**	wheel Ø 150–200 mm**	all

** Only for swivel castors without brake or swivel castor with "stop-top" and "central-stop" brake upon request

LK-ALB, BK-ALB, BH-ALB series

Pressed steel castors, heavy-duty design, with top plate, wheel with Blickle Besthane® polyurethane tread

350–600 kg

Bracket: LK/BK/BH series

- strong pressed steel, zinc-plated, blue-passivated, Cr6-free

Swivel bracket:

- double ball bearing in the swivel head
- strong central kingpin (from wheel Ø 125x50 mm)
- swivel head seal
- minimum swivel head play and smooth rolling characteristic and increased service life due to the special dynamic Blickle riveting process

Wheel: ALB series

- tread: high-quality polyurethane elastomer Blickle Besthane®, hardness 92 Shore A, colour brown, non-marking, non-staining
- wheel centre: die-cast aluminium, colour silver grey

Additional details:

- bracket series: page 92
- brakes: page 112–113
- wheel series: page 307
- bearing types: page 84–85

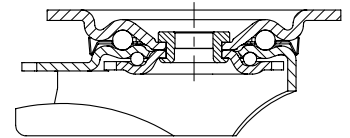

5

Swivel castors	Fixed castors	Swivel castors with "stop-fix" brake	Wheel Ø [mm]	Wheel width [mm]	Load capacity [kg]	Bearing type	Total height [mm]	Plate size [mm]	Bolt hole spacing [mm]	Bolt hole Ø [mm]	Offset swivel castor [mm]
LK-ALB 101K-1	BK-ALB 101K-1	LK-ALB 101K-1-FI	100	40	350	ball bearing	130	100 x 85	80 x 60	9	45
LK-ALB 101K-3	BK-ALB 101K-3	LK-ALB 101K-3-FI	100	40	350	ball bearing	130	140 x 110	105 x 75–80	11	45
LK-ALB 125K-1	BK-ALB 125K-1	LK-ALB 125K-1-FI	125	40	350	ball bearing	155	100 x 85	80 x 60	9	48
LK-ALB 125K-3	BK-ALB 125K-3	LK-ALB 125K-3-FI	125	40	350	ball bearing	155	140 x 110	105 x 75–80	11	48
LK-ALB 150K	BH-ALB 150K	LK-ALB 150K-FI	150	50	600	ball bearing	197	140 x 110	105 x 75–80	11	60
LK-ALB 160K	BH-ALB 160K	LK-ALB 160K-FI	160	50	600	ball bearing	202	140 x 110	105 x 75–80	11	60
LK-ALB 200K	BH-ALB 200K	LK-ALB 200K-FI	200	50	600	ball bearing	245	140 x 110	105 x 75–80	11	62

Versions / options



	with "stop-top" brake	with "ideal-stop" brake total height +17 mm	with directional lock (separate) 1x 360°	with steel foot guard
Technical description page	112	112	115	116
Product code suffix	-ST	-IS	see **	-FS
Available for	all	wheel Ø 160+200 mm*	for wheel Ø and plate dimensions, see**	upon request

* Synthetic adapter plate to balance out total height for swivel and fixed castors without "ideal-stop" brake: **product code AP3-17**

** **RI-05.01** for wheel Ø 100–125 mm with plate 100x85 mm, **RI-03.03** for wheel Ø 100–125 mm with plate 140x110 mm, **RI-05.03** for wheel Ø 150–200 mm (Only for swivel castors without brake or swivel castor with "stop-top" brake upon request)

LH-ALB, BH-ALB series

Pressed steel castors, heavy-duty design, with top plate, wheel with Blickle Besthane® polyurethane tread

400–900 kg

Bracket: LH/BH series

- strong pressed steel, zinc-plated, blue-passivated, Cr6-free
- heavy fork and top plate

Swivel bracket:

- double ball bearing in the swivel head
- bolted and secured central kingpin, extremely strong
- particularly resistant to shocks and impact due to **four specially-shaped, hardened bearing seats**

Wheel: ALB series

- tread: high-quality polyurethane elastomer Blickle Besthane®, hardness 92 Shore A, colour brown, non-marking, non-staining
- wheel centre: die-cast aluminium, colour silver grey

Additional details:

- bracket series: page 92
- brakes: page 112–113
- wheel series: page 307
- bearing types: page 84–85



5

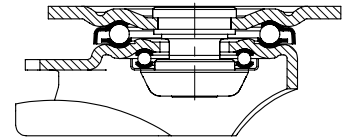

Swivel castors	Fixed castors	Swivel castors with "stop-fix" brake	Wheel Ø [mm]	Wheel width [mm]	Load capacity [kg]	Bearing type	Total height [mm]	Plate size [mm]	Bolt hole spacing [mm]	Bolt hole Ø [mm]	Offset swivel castor [mm]
LH-ALB 101K-1 *	BH-ALB 101K-1 *	LH-ALB 101K-1-FI *	100	40	400	ball bearing	140	100 x 85	80 x 60	9	45
LH-ALB 101K-3 *	BH-ALB 101K-3 *	LH-ALB 101K-3-FI *	100	40	400	ball bearing	140	140 x 110	105 x 75–80	11	45
LH-ALB 125K-1	BH-ALB 125K-1	LH-ALB 125K-1-FI	125	40	550	ball bearing	165	100 x 85	80 x 60	9	45
LH-ALB 125K-3	BH-ALB 125K-3	LH-ALB 125K-3-FI	125	40	550	ball bearing	165	140 x 110	105 x 75–80	11	45
LH-ALB 150K	BH-ALB 150K	LH-ALB 150K-FI	150	50	650	ball bearing	197	140 x 110	105 x 75–80	11	65
LH-ALB 152K *	BH-ALB 152K *	LH-ALB 152K-FI *	150	54	900	ball bearing	197	140 x 110	105 x 75–80	11	65
LH-ALB 160K	BH-ALB 160K	LH-ALB 160K-FI	160	50	750	ball bearing	202	140 x 110	105 x 75–80	11	65
LH-ALB 162K *	BH-ALB 162K *	LH-ALB 162K-FI *	160	50	900	ball bearing	202	140 x 110	105 x 75–80	11	65
LH-ALB 200K	BH-ALB 200K	LH-ALB 200K-FI	200	50	800	ball bearing	245	140 x 110	105 x 75–80	11	70
LH-ALB 202K *	BH-ALB 202K *	LH-ALB 202K-FI *	200	50	900	ball bearing	245	140 x 110	105 x 75–80	11	70
LH-ALB 250K	BH-ALB 250K	**	250	60	900	ball bearing	295	140 x 110	105 x 75–80	11	82
LH-ALB 252K *	BH-ALB 252K *	**	250	60	900	ball bearing	295	140 x 110	105 x 75–80	11	82

* Heavy-duty wheel version

** "stop-top" brake version, see versions / options

Versions / options



	version with heavy duty wheel centre, reinforced design	with "stop-top" brake	with "central-stop" central brake system	with "ideal-stop" brake total height +17 mm	with directional lock (separate) 1x 360°	with steel foot guard	truck lock
Technical description page		112	113	112	115	116	114
Product code suffix		-ST	-CS13	-IS	see ****	-FS	FF 125 / 150 / 160 / 200
Available for		all	wheel Ø 160–200 mm	wheel Ø 160–200 mm***	for wheel Ø and plate dimensions, see****	all	wheel Ø 125, 150, 160, 200 mm

*** Synthetic adapter plate to balance out total height for swivel and fixed castors without "ideal-stop" brake: **product code AP3-17**

**** **RI-04.01** for wheel Ø 100–125 mm with plate 100x85 mm, **RI-04.03** for wheel Ø 100–125x40 mm with plate 140x110 mm, **RI-05.03** for wheel Ø 125x54–200 mm (Only for swivel castors without brake or swivel castor with "stop-top" and "central-stop" brake upon request)

LHD-ALB, BOD-ALB series

Pressed steel twin wheel castors, heavy-duty design, with top plate, wheels with Blickle Besthane® polyurethane tread



720–900 kg

Bracket: LHD/BOD series

- strong pressed steel, zinc-plated, blue-passivated, Cr6-free (fixed bracket: solid welded steel construction)
- heavy fork and top plate

Swivel bracket:

- double ball bearing in the swivel head
- bolted and secured central kingpin, extremely strong
- particularly resistant to shocks and impact due to **four specially-shaped, hardened bearing seats**

Wheel: ALB series

- tread: high-quality polyurethane elastomer Blickle Besthane®, hardness 92 Shore A, colour brown, non-marking, non-staining
- wheel centre: die-cast aluminium, colour silver grey

Additional details:

- bracket series: page 93
- wheel series: page 307
- bearing types: page 84–85

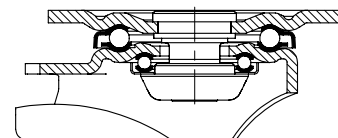

Swivel castors	Fixed castors	Wheel Ø [mm]	Wheel width [mm]	Load capacity [kg]	Bearing type	Total height [mm]	Plate size [mm]	Bolt hole spacing [mm]	Bolt hole Ø [mm]	Offset swivel castor [mm]
LHD-ALB 101K *	BOD-ALB 101K *	100	2 x 40	720	ball bearing	145	140 x 110	105 x 75–80	11	45
LHD-ALB 125K	BOD-ALB 125K	125	2 x 40	900	ball bearing	170	140 x 110	105 x 75–80	11	50
LHD-ALB 181K	BOD-ALB 181K	180	2 x 44	800	ball bearing	235	140 x 110	105 x 75–80	11	65

* Heavy-duty wheel version

Fixed castors: long side of plate parallel to the wheel axle

Versions / options



	truck lock
Technical description page	114
Product code suffix	FF 100-1 / FF 125-1 / FF 200
Available for	all**

** FF 200 suitable for LHD-...wheel Ø 180 mm

VSB, GB series, wheel Ø 80–200 mm

Heavy-duty wheels
with **Blickle Besthane® polyurethane tread**,
with **steel or cast iron wheel centre**



450–1,600 kg

Tread and tyre hardness
 92 Shore A

Smooth operation / floor preservation
 good

Rolling resistance
 excellent

Wear resistance
 excellent



Tread:

- high-quality polyurethane elastomer Blickle Besthane®, hardness 92 Shore A
- very low rolling resistance
- **high dynamic load capacity**
- high abrasion resistance
- high cut and tear propagation resistance
- colour brown, non-marking, non-staining
- excellent chemical connection with the wheel centre

Wheel centre:

- series VSB: steel
- series GB: rugged grey cast iron, with grease nipple from wheel Ø 150 mm, lacquered, colour silver

Other features:

- high chemical resistance to many aggressive substances
- operating temperature: -20 °C to +70 °C, temporarily up to +90 °C, reduced load capacity over +40 °C

Additional details:

- wheel series: page 67
- tread: page 56
- bearing types: page 84–85
- chemical resistance: page 51

Wheels	Wheel Ø (D) [mm]	Wheel width (T2) [mm]	Load capacity at 4 km/h [kg]	Load capacity at 10 km/h [kg]	Load capacity at 16 km/h [kg]	Bearing type	Axle bore Ø (d) [mm]	Hub length (T1) [mm]
VSB 82/20K	80	70	500	–	–	ball bearing	20	70
GB 100/15K	100	40	450	–	–	ball bearing	15	40
GB 101/20-50K	100	50	600	–	–	ball bearing	20	50
GB 101/20K	100	50	600	–	–	ball bearing	20	60
GB 125/15K	125	40	550	–	–	ball bearing	15	45
GB 128/20K	125	60	850	590	340	ball bearing	20	60
GB 140/20K	140	54	900	630	360	ball bearing	20	60
GB 150/20-50K	150	50	800	560	320	ball bearing	20	50
GB 150/20K	150	50	800	560	320	ball bearing	20	60
GB 152/20K	150	60	950	660	380	ball bearing	20	60
GB 152/25K	150	60	950	660	380	ball bearing	25	60
GB 154/25K	150	80	1,200	840	480	ball bearing	25	80
GB 160/20K	160	50	800	560	320	ball bearing	20	60
GB 160/25K	160	50	800	560	320	ball bearing	25	60
GB 180/20K	180	50	1,000	700	400	ball bearing	20	60
GB 180/25K	180	50	1,000	700	400	ball bearing	25	60
GB 182/25K	180	65	1,100	770	440	ball bearing	25	75
GB 184/25K	180	80	1,400	980	560	ball bearing	25	80
GB 200/20K	200	50	1,000	700	400	ball bearing	20	60
GB 200/25K	200	50	1,000	700	400	ball bearing	25	60
GB 201/25K	200	60	1,400	980	560	ball bearing	25	60
GB 202/25K	200	80	1,600	1,100	640	ball bearing	25	90
GB 202/30K	200	80	1,600	1,100	640	ball bearing	30	90
GB 202/35K	200	80	1,600	1,100	640	ball bearing	35	90

Greatly increased load capacity is possible for applications without obstacles.

For other wheel Ø, see next page

Versions / options



	hydrolysis resistant, with cast nylon wheel centre	drive wheels with hub keyway	hub fitting wheels	electrically conductive version, non-marking	other shore hardnesses and special colours
Technical description page	56	76	78	50	
Product code suffix	GSPOB series	GBN series	GBA series	-ELS	
Available for	upon request	see page 544–545	see page 552	upon request	upon request

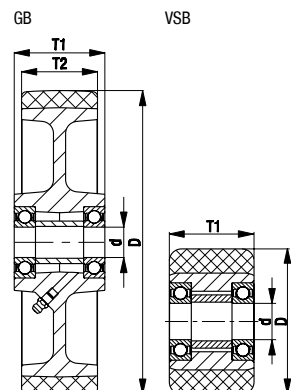

GB series, wheel Ø 250–1,000 mm

Heavy-duty wheels
with **Blickle Besthane® polyurethane tread**,
with **cast iron wheel centre**



1,250–30,000 kg

Tread and tyre hardness
 92 Shore A

Smooth operation / floor preservation
 good

Rolling resistance
 excellent

Wear resistance
 excellent



- Tread:**
- high-quality polyurethane elastomer Blickle Besthane®, hardness 92 Shore A
 - very low rolling resistance
 - high dynamic load capacity**
 - high abrasion resistance
 - high cut and tear propagation resistance
 - colour brown, non-marking, non-staining
 - excellent chemical connection with the wheel centre

- Wheel centre:**
- rugged grey cast iron
 - with grease nipple
 - lacquered, colour silver

- Other features:**
- high chemical resistance to many aggressive substances
 - operating temperature: -20 °C to +70 °C, temporarily up to +90 °C, reduced load capacity over +40 °C

- Additional details:**
- wheel series: page 67
 - tread: page 56
 - bearing types: page 84–85
 - chemical resistance: page 51

Wheels	Wheel Ø (D) [mm]	Wheel width (T2) [mm]	Load capacity at 4 km/h [kg]	Load capacity at 10 km/h [kg]	Load capacity at 16 km/h [kg]	Bearing type	Axle bore Ø (d) [mm]	Hub length (T1) [mm]
GB 251/25K	250	50	1,250	870	500	ball bearing	25	60
GB 251/30K	250	50	1,250	870	500	ball bearing	30	60
GB 250/25K	250	60	1,500	1,050	600	ball bearing	25	70
GB 250/30K	250	60	1,500	1,050	600	ball bearing	30	70
GB 250/30K-01	250	60	1,750	1,200	700	ball bearing	30	70
GB 250/35K	250	60	1,500	1,050	600	ball bearing	35	70
GB 252/25K	250	80	1,800	1,250	720	ball bearing	25	90
GB 252/30K	250	80	2,200	1,550	880	ball bearing	30	90
GB 253/35K	250	100	2,650	1,850	1,050	ball bearing	35	100
GB 254/40K	250	130	3,150	2,200	1,250	ball bearing	40	140
GB 300/30K	300	60	1,800	1,250	720	ball bearing	30	70
GB 302/30K	300	80	2,400	1,650	960	ball bearing	30	90
GB 302/35K	300	80	2,400	1,650	960	ball bearing	35	90
GB 304/35K	300	100	3,000	2,100	1,200	ball bearing	35	120
GB 306/50K	300	140	3,700	2,600	1,500	ball bearing	50	140
GB 360/40K	360	75	2,500	1,750	1,000	ball bearing	40	90
GB 362/40K	360	80	3,000	2,100	1,200	ball bearing	40	90
GB 363/40K	360	100	3,600	2,500	1,450	ball bearing	40	100
GB 364/40K	360	120	3,800	2,650	1,500	ball bearing	40	120
GB 402/40K	400	80	3,000	2,100	1,200	ball bearing	40	90
GB 404/40K	400	100	3,800	2,650	1,500	ball bearing	40	120
GB 406/50K	400	125	5,000	3,500	2,000	ball bearing	50	125
GB 408/50K	400	150	5,700	4,000	2,250	ball bearing	50	150
GB 500/50K	500	100	5,000	3,500	2,000	ball bearing	50	100
GB 504/60K	500	150	7,500	5,250	3,000	ball bearing	60	150
GB 506/80K	500	200	10,000	7,000	4,000	ball bearing	80	200
GB 602/80K	600	150	9,000	6,300	3,600	ball bearing	80	150
GB 604/80K	600	200	12,000	8,400	4,800	ball bearing	80	200
GB 750/120K	750	200	15,000	10,500	6,000	ball bearing	120	200
GB 1000/160PR	1,000	300	30,000	21,000	12,000	spherical roller bearing	160	330

Greatly increased load capacity is possible for applications without obstacles.
Other dimensions available upon request

Versions / options



	hydrolysis resistant, with cast nylon wheel centre	drive wheels with hub keyway	hub fitting wheels	electrically conductive version, non-marking	other shore hardnesses and special colours
Technical description page	56	76	78	50	
Product code suffix	GSPOB series	GBN series	GBA series	-ELS	
Available for	upon request	see page 544–545	see page 552	up to wheel Ø 300 mm upon request	upon request

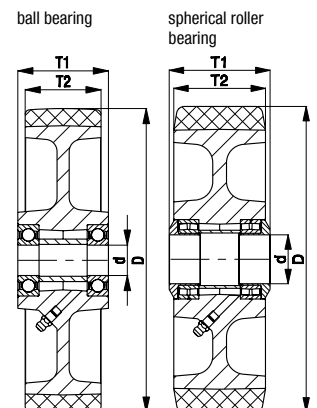

LH-VSB, LH-GB, BH-GB series

Pressed steel castors, heavy-duty design, with top plate, wheel with Blickle Besthane® polyurethane tread

450–900 kg



Bracket: LH/BH series

- strong pressed steel, zinc-plated, blue-passivated, Cr6-free
- heavy fork and top plate

Swivel bracket:

- double ball bearing in the swivel head
- bolted and secured central kingpin, extremely strong
- particularly resistant to shocks and impact due to **four specially-shaped, hardened bearing seats**

Wheel: VSB/GB series

- tread: high-quality polyurethane elastomer Blickle Besthane®, hardness 92 Shore A, colour brown, non-marking, non-staining

wheel centre:

- VSB series: steel
- GB series: rugged grey cast iron, with grease nipple from wheel Ø 150 mm, lacquered, colour silver

Additional details:

- bracket series: page 92
- brakes: page 112–113
- wheel series: page 312–313
- bearing types: page 84–85



5

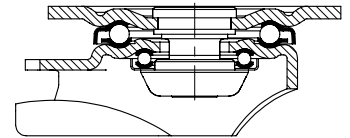

Swivel castors	Fixed castors	Swivel castors with "stop-fix" brake	Wheel Ø [mm]	Wheel width [mm]	Load capacity [kg]	Bearing type	Total height [mm]	Plate size [mm]	Bolt hole spacing [mm]	Bolt hole Ø [mm]	Offset swivel castor [mm]
LH-VSB 82K			80	70	500	ball bearing	112	100 x 85	80 x 60	9	45
LH-GB 100K-1	BH-GB 100K-1	LH-GB 100K-1-FI	100	40	450	ball bearing	140	100 x 85	80 x 60	9	45
LH-GB 100K-3	BH-GB 100K-3	LH-GB 100K-3-FI	100	40	450	ball bearing	140	140 x 110	105 x 75–80	11	45
LH-GB 125K-1	BH-GB 125K-1	LH-GB 125K-1-FI	125	40	550	ball bearing	165	100 x 85	80 x 60	9	45
LH-GB 125K-3	BH-GB 125K-3	LH-GB 125K-3-FI	125	40	550	ball bearing	165	140 x 110	105 x 75–80	11	45
LH-GB 128K	BH-GB 128K	LH-GB 128K-FI	125	60	850	ball bearing	170	140 x 110	105 x 75–80	11	55
LH-GB 150K	BH-GB 150K	LH-GB 150K-FI	150	50	800	ball bearing	197	140 x 110	105 x 75–80	11	65
LH-GB 160K	BH-GB 160K	LH-GB 160K-FI	160	50	800	ball bearing	202	140 x 110	105 x 75–80	11	65
LH-GB 180K	BH-GB 180K	LH-GB 180K-FI	180	50	900	ball bearing	223	140 x 110	105 x 75–80	11	65
LH-GB 200K	BH-GB 200K	LH-GB 200K-FI	200	50	900	ball bearing	245	140 x 110	105 x 75–80	11	70
LH-GB 202K	BO-GB 202K *	**	200	80	800	ball bearing	245	140 x 110	105 x 75–80	11	70
LH-GB 250K	BH-GB 250K	**	250	60	900	ball bearing	295	140 x 110	105 x 75–80	11	82

* Welded steel construction

** "stop-top" brake version, see versions / options

Versions / options***



	hydrolysis resistant, with cast nylon wheel centre	electrically conductive version, non-marking	with "stop-top" brake	with "central-stop" central brake system	with "ideal-stop" brake total height +17 mm	with directional lock (separate) 1x 360°	truck lock
Technical description page	56	50	112	113	112	115	114
Product code suffix	GSP0B series	-ELS	-ST	-CS13	-IS	see *****	FF 125 / 150 / 160 / 200
Available for	upon request	upon request	wheel Ø 100–250 mm	wheel Ø 160+200x50 mm	wheel Ø 160+200 mm****	for wheel Ø and plate dimensions, see*****	wheel Ø 125x60, 150, 160, 200 mm

*** **Additional versions / options:** with steel foot guard (-FS), available for wheel Ø 100–250 mm

**** Synthetic adapter plate to balance out total height for swivel and fixed castors without "ideal-stop" brake: **product code AP3-17**

***** **RI-04.01** for wheel Ø 100–125 mm with plate 100x85 mm, **RI-04.03** for wheel Ø 100–125x40 mm with plate 140x110 mm, **RI-05.03** for wheel Ø 125x60–200x50 mm (Only for swivel castors without brake or swivel castor with "stop-top" and "central-stop" brake upon request)

LUH-GB, BH-GB series

Pressed steel castors, heavy-duty design, enclosed, with top plate, wheel with Blickle Besthane® polyurethane tread

800–1,000 kg

Bracket: LUH/BH series

- strong pressed steel, zinc-plated, blue-passivated, Cr6-free

Swivel bracket:

- four-point ball bearing for extremely heavy loads
- enclosed and sealed swivel head
- particularly resistant to shocks and impact due to **specialty-shaped, hardened bearing seats**

Wheel: GB series

- tread: high-quality polyurethane elastomer Blickle Besthane®, hardness 92 Shore A, colour brown, non-marking, non-staining
- wheel centre: rugged grey cast iron, with grease nipple from wheel Ø 150 mm, lacquered, colour silver

Additional details:

- bracket series: page 93
- brakes: page 112–113
- wheel series: page 312
- bearing types: page 84–85

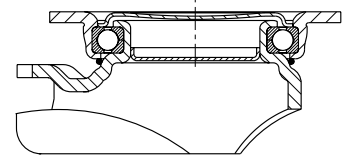

5

Swivel castors	Fixed castors	Swivel castors with "stop-fix" brake	Wheel Ø [mm]	Wheel width [mm]	Load capacity [kg]	Bearing type	Total height [mm]	Plate size [mm]	Bolt hole spacing [mm]	Bolt hole Ø [mm]	Offset swivel castor [mm]
LUH-GB 128K	BH-GB 128K	LUH-GB 128K-FI	125	60	850	ball bearing	170	140 x 110	105 x 75–80	11	55
LUH-GB 150K	BH-GB 150K	LUH-GB 150K-FI	150	50	800	ball bearing	197	140 x 110	105 x 75–80	11	61
LUH-GB 160K	BH-GB 160K	LUH-GB 160K-FI	160	50	800	ball bearing	202	140 x 110	105 x 75–80	11	61
LUH-GB 200K	BH-GB 200K	LUH-GB 200K-FI	200	50	1,000	ball bearing	245	140 x 110	105 x 75–80	11	63

Versions / options



	hydrolysis resistant, with cast nylon wheel centre	electrically conductive version, non-marking	directional lock (separate) 1 x 360°	with steel foot guard
Technical description page	56	50	115	116
Product code suffix	GSP0B series	-ELS	RI-05.03	-FS
Available for	upon request	upon request	all*	upon request

* Only for swivel castors without brake

LS-GB, BS-GB series

Welded steel heavy-duty castors, heavy-duty swivel head, wheel with Blickle Besthane® polyurethane tread

800–12,000 kg

Bracket: LS/BS series

- particularly robust welded steel construction, zinc-plated, yellow-passivated, Cr6-free

Swivel bracket:

- axial grooved ball bearing ISO 104 and tapered roller bearing ISO 355 in the swivel head
- bolted and secured welded central kingpin, extremely strong
- dust and splash-proof
- grease nipple

Wheel: GB series

- tread: high-quality polyurethane elastomer Blickle Besthane®, hardness 92 Shore A, colour brown, non-marking, non-staining
- wheel centre: rugged grey cast iron, with grease nipple from wheel Ø 150 mm, lacquered, colour silver

Additional details:

- bracket series: page 94
- brakes: page 112–113
- wheel series: page 312–313
- bearing types: page 84–85



5

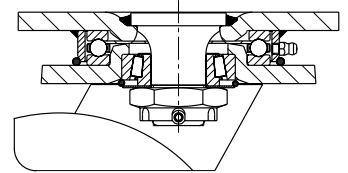

Swivel castors	Fixed castors	Swivel castor with "stop-top" brake	Wheel Ø [mm]	Wheel width [mm]	Load capacity [kg]	Bearing type	Total height [mm]	Plate size [mm]	Bolt hole spacing [mm]	Bolt hole Ø [mm]	Offset swivel castor [mm]
LS-GB 128K	BS-GB 128K	LS-GB 128K-ST	125	60	850	ball bearing	170	140 x 110	105 x 75–80	11	50
LS-GB 150K	BS-GB 150K	LS-GB 150K-ST	150	50	800	ball bearing	200	140 x 110	105 x 75–80	11	55
LS-GB 152K	BS-GB 152K	LS-GB 152K-ST	150	60	950	ball bearing	200	140 x 110	105 x 75–80	11	55
LS-GB 154K	BS-GB 154K	LS-GB 154K-ST	150	80	1,200	ball bearing	205	175 x 140	140 x 105	14	65
LS-GB 160K	BS-GB 160K	LS-GB 160K-ST	160	50	800	ball bearing	205	140 x 110	105 x 75–80	11	55
LS-GB 200K	BS-GB 200K	LS-GB 200K-ST	200	50	1,000	ball bearing	245	140 x 110	105 x 75–80	11	60
LS-GB 202K	BS-GB 202K	LS-GB 202K-ST	200	80	1,600	ball bearing	255	175 x 140	140 x 105	14	65
LS-GB 250K	BS-GB 250K	LS-GB 250K-ST	250	60	1,500	ball bearing	305	175 x 140	140 x 105	14	75
LS-GB 252K	BS-GB 252K	LS-GB 252K-ST	250	80	1,800	ball bearing	305	175 x 140	140 x 105	14	75
LS-GB 300K	BS-GB 300K	LS-GB 300K-ST	300	60	1,800	ball bearing	355	175 x 140	140 x 105	14	85
LS-GB 302K	BS-GB 302K	LS-GB 302K-ST	300	80	2,400	ball bearing	355	175 x 140	140 x 105	14	85
LS-GB 304K	BS-GB 304K	*	300	100	3,000	ball bearing	370	200 x 160	160 x 120	14	85
LS-GB 360K	BS-GB 360K	*	360	75	2,500	ball bearing	430	200 x 160	160 x 120	14	100
LS-GB 364K	BS-GB 364K	*	360	120	3,800	ball bearing	430	255 x 200	210 x 160	18	100
LS-GB 402K	BS-GB 402K	*	400	80	3,000	ball bearing	470	200 x 160	160 x 120	14	100
LS-GB 406K	BS-GB 406K	*	400	125	5,000	ball bearing	480	255 x 200	210 x 160	18	125
LS-GB 504K	BS-GB 504K	*	500	150	7,500	ball bearing	630	400 x 300	340 x 240	26	125
LS-GB 604K	BS-GB 604K	*	600	200	12,000	ball bearing	730	400 x 300	340 x 240	26	130

* "Radstop" brake version

Versions / options



	hydrolysis resistant, with cast nylon wheel centre	electrically conductive version, non-marking	with "Radstop" wheel brake	with directional lock 4 x 90°	with directional lock 4 x 90° (inserted by hand)	with steel foot guard	truck lock
Technical description page	56	50	113	115	115	116	114
Product code suffix	GSP0B series	-ELS	-RAH	-RI4	-RI4H	-FS	FF 125 / 150 / 160 / 200
Available for	upon request	up to wheel Ø 300 mm upon request	from wheel Ø 300x100 mm upon request	wheel Ø 125–300x80 mm	from wheel Ø 300x100 mm upon request	wheel Ø 125–250 mm	wheel Ø 125–200x50 mm

LSD-GB, BSD-GB series

Welded steel heavy-duty twin wheel castors, heavy-duty swivel head, wheels with Blickle Besthane® polyurethane tread

810–12,000 kg

Bracket: LSD/BSD series

- particularly robust welded steel construction, zinc-plated, yellow-passivated, Cr6-free

Swivel bracket:

- axial grooved ball bearing ISO 104 and tapered roller bearing ISO 355 in the swivel head
- bolted and secured welded central kingpin, extremely strong
- dust and splash-proof
- grease nipple

Wheel: GB series

- tread: high-quality polyurethane elastomer Blickle Besthane®, hardness 92 Shore A, colour brown, non-marking, non-staining
- wheel centre: rugged grey cast iron, with grease nipple from wheel Ø 150 mm, lacquered, colour silver

Additional details:

- bracket series: page 94
- brakes: page 112–113
- wheel series: page 312–313
- bearing types: page 84–85

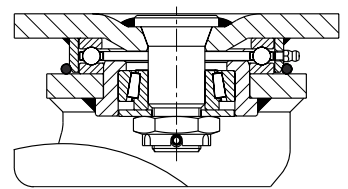
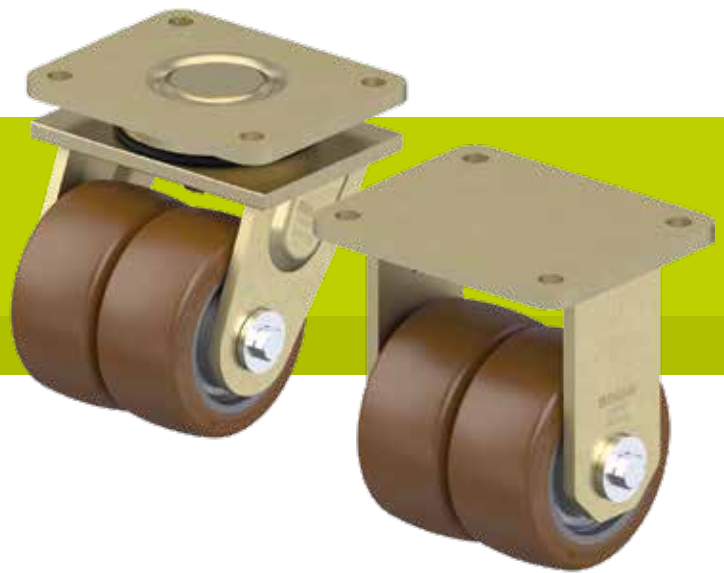

5

Swivel castors	Fixed castors	Wheel Ø [mm]	Wheel width [mm]	Load capacity [kg]	Bearing type	Total height [mm]	Plate size [mm]	Bolt hole spacing [mm]	Bolt hole Ø [mm]	Offset swivel castor [mm]
LSD-GB 100K	BSD-GB 100K	100	2 x 40	810	ball bearing	145	140 x 110	105 x 75–80	11	45
LSD-GB 128K	BSD-GB 128K	125	2 x 60	1,500	ball bearing	185	175 x 140	140 x 105	14	50
LSD-GB 150K-35	BSD-GB 150K-35	150	2 x 50	1,400	ball bearing	215	175 x 140	140 x 105	14	55
LSD-GB 200K-35	BSD-GB 200K-35	200	2 x 50	1,800	ball bearing	260	175 x 140	140 x 105	14	60
LSD-GB 202K	BSD-GB 202K	200	2 x 80	2,850	ball bearing	280	255 x 200	210 x 160	18	60
LSD-GB 250K	BSD-GB 250K	250	2 x 60	2,700	ball bearing	330	255 x 200	210 x 160	18	70
LSD-GB 252K	BSD-GB 252K	250	2 x 80	3,700	ball bearing	330	255 x 200	210 x 160	18	70
LSD-GB 302K	BSD-GB 302K	300	2 x 80	4,300	ball bearing	390	255 x 200	210 x 160	18	80
LSD-GB 304K		300	2 x 100	5,400	ball bearing	390	255 x 200	210 x 160	18	80
	BSD-GB 304K	300	2 x 100	5,400	ball bearing	390	300 x 200	210 x 160	18	–
LSD-GB 404K-42	BSD-GB 404K-42	400	2 x 100	6,800	ball bearing	530	400 x 300	340 x 240	26	125
LSD-GB 504K	BSD-GB 504K	500	2 x 150	12,000	ball bearing	630	400 x 300	340 x 240	26	125

Fixed castors: long side of plate parallel to the wheel axle

Versions / options



	hydrolysis resistant, with cast nylon wheel centre	electrically conductive version, non-marking	with "Radstop" wheel brake	with "Radstop" wheel brake	with directional lock 4 x 90°	with directional lock 4 x 90° (inserted by hand)	with steel foot guard
Technical description page	56	50	113	113	115	115	116
Product code suffix	GSP0B series	-ELS	-RA	-RAH	-RI4	-RI4H	-FS
Available for	upon request	up to wheel Ø 300 mm upon request	up to wheel Ø 200x50 mm upon request	from wheel Ø 200x80 mm upon request	wheel Ø 100–200x50 mm upon request	from wheel Ø 200x80 mm upon request	upon request